

4.8



★ Trustpilot



NEW

Shaker Wall Panelling Kits Half Height

Includes step-by-step
installation guide



Shaker Wall Panelling Kits - Half Height

Includes step-by-step installation guide



Please Note:

A back board **is not included** in this kit, you will only receive MDF strips to create the panel effect. If your wall has imperfections and you need a back board to cover them purchase MDF sheets cut to size separately.

Step 1



Step 2

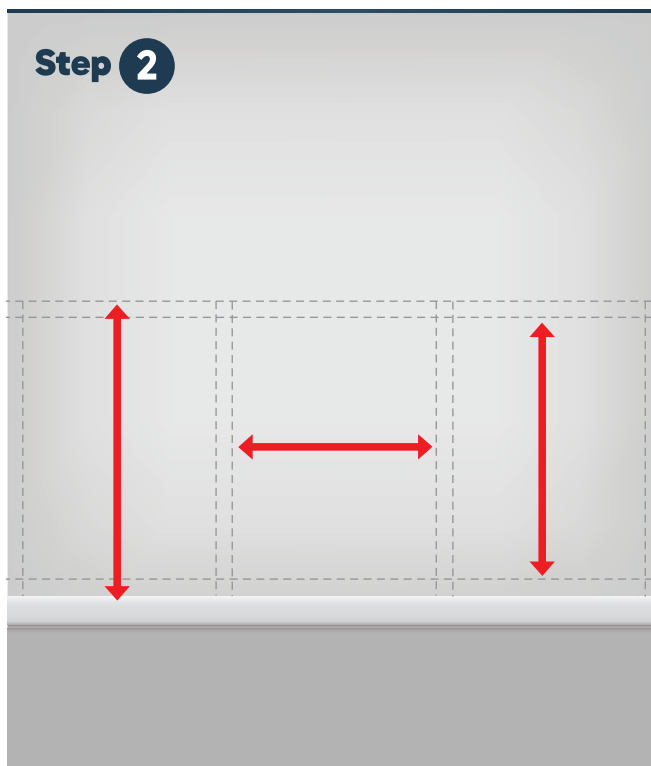

How To Install Shaker Panelling

Shaker wall panelling is installed by fixing evenly spaced MDF strips to a wall to create a framed grid design. Installation involves measuring and marking the layout, fixing outer frame pieces first, then installing internal vertical and horizontal strips. Once fitted, joints are filled, sanded and painted for a seamless finish.

What Is Shaker Panelling?

Shaker panelling is a decorative wall treatment made from evenly spaced vertical and horizontal strips. It creates a clean, square-edged grid pattern often used in living rooms, hallways, staircases and bedrooms.

Modern shaker panels are typically made from MDF due to its smooth surface and ease of painting.

Tools & Materials Required

Tools:

- Tape measure.
- Spirit level or laser level.
- Pencil.
- Mitre saw or fine-tooth hand saw.
- Caulking gun.
- Sandpaper.

Materials:

- MDF shaker panel strips or kit.
- Grab adhesive (high-strength).
- Decorators caulk or filler.
- Primer suitable for MDF.
- Paint (eggshell, satin or matt finish).

Best MDF Thickness For Shaker Panels

9mm or 12mm MDF is typically used for shaker strips. Thicker boards create a deeper shadow line and more pronounced finish.

Measure Your Wall

Measure the total height and width of the wall. Decide on your layout style (full wall grid, half-height panelling, or feature panels). Sketch the design before starting to ensure symmetry and equal spacing.

Note: You will only receive MDF strips to create the panel effect.

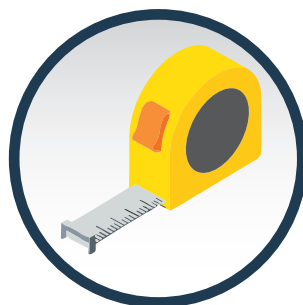

Mark The Layout

Using a level, mark the outer frame first. This usually includes:

- A top horizontal rail.
- A bottom rail (if full height).
- Side vertical pieces.

Mark internal vertical sections evenly. Spacing should remain consistent across the wall for a professional finish.

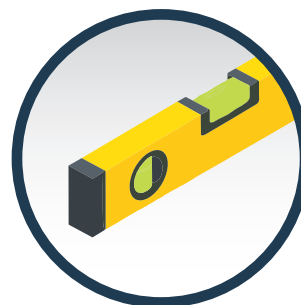

Visit us online at www.theplasticpeople.co.uk



Shaker Wall Panelling Kits - Half Height

Includes step-by-step installation guide



Please Note:

A back board **is not included** in this kit, you will only receive MDF strips to create the panel effect. If your wall has imperfections and you need a back board to cover them purchase MDF sheets cut to size separately.

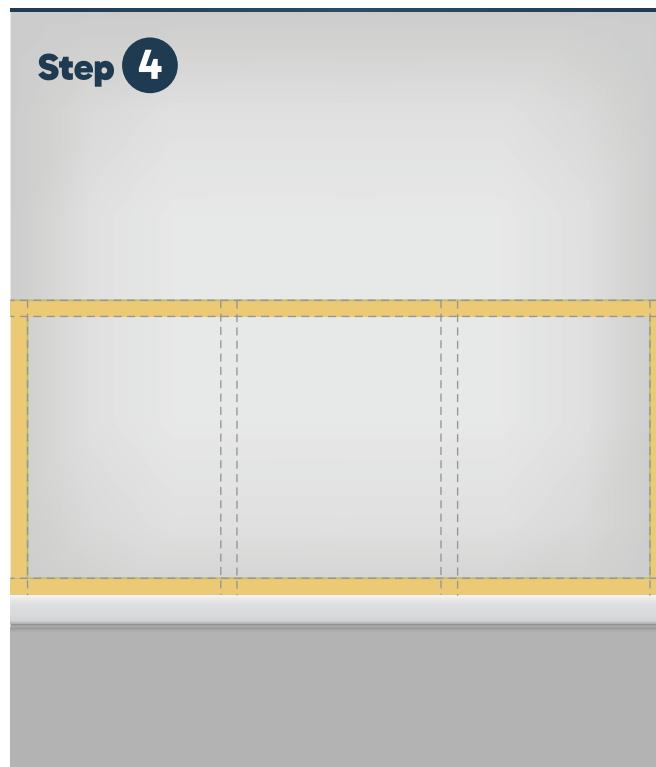
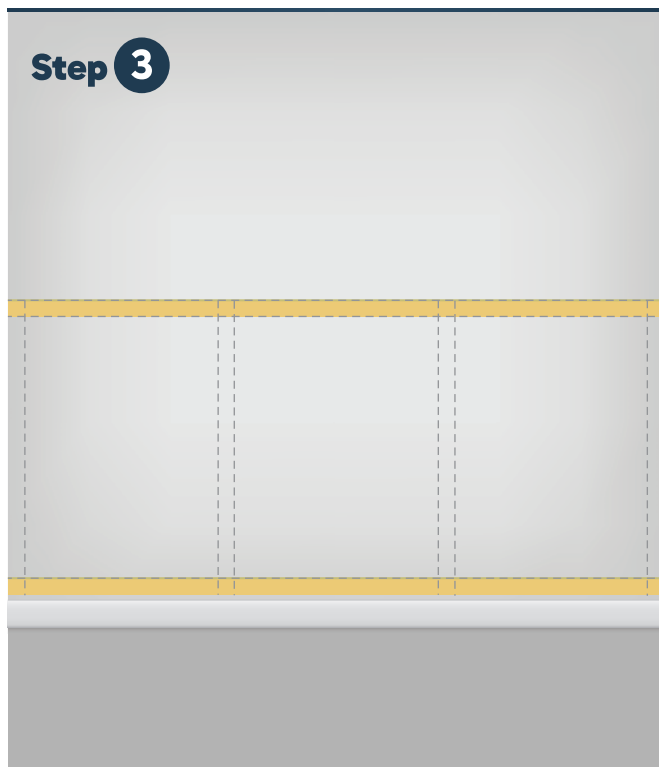

Common Mistakes to Avoid

- Not using a level – uneven lines are highly visible.
- Inconsistent spacing.
- Skipping primer – MDF absorbs paint without sealing.
- Installing before planning layout fully.
- Using standard MDF in high-humidity areas without sealing.

Where Can Shaker Panelling Be Installed?

Shaker panels are commonly installed in:

- Living rooms
- Hallways and staircases
- Bedrooms
- Dining rooms
- Home offices

Moisture-resistant MDF should be used in areas with occasional humidity.

Why Use an MDF Shaker Panel Kit?

Pre-cut shaker panel kits reduce measuring time and material waste. They provide consistent strip width and thickness, helping achieve a clean, professional finish.



■ Cut The MDF Strips

If not supplied pre-cut, cut MDF strips to length using a mitre saw or fine-tooth hand saw. Check each piece against the wall before applying adhesive.

Note: You will only receive MDF strips to create the panel effect.

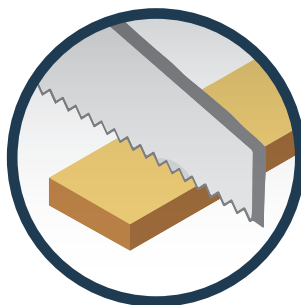

■ Fix The Outer Frame First

Apply grab adhesive to the back of each strip in a zig-zag pattern. Press firmly onto the wall and check alignment with a level. Fix the full perimeter before installing internal pieces.

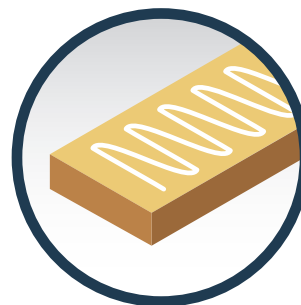

Shaker Wall Panelling Kits - Half Height

Includes step-by-step installation guide



Please Note:

A back board **is not included** in this kit, you will only receive MDF strips to create the panel effect. If your wall has imperfections and you need a back board to cover them purchase MDF sheets cut to size separately.

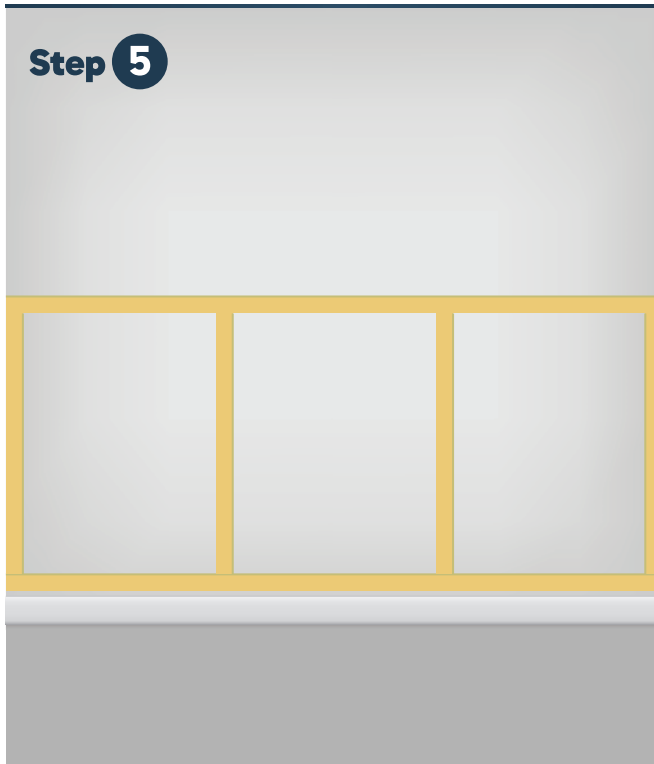

Step 5

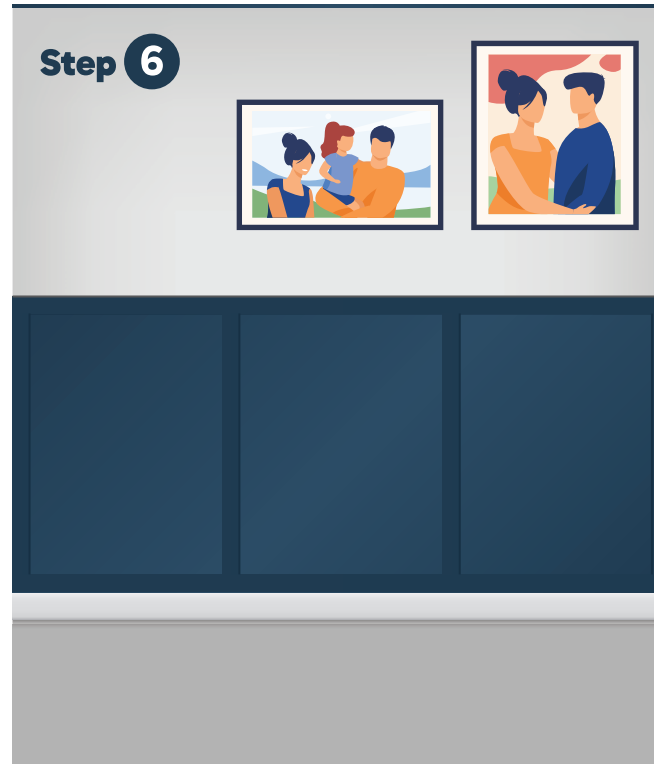

Step 6

Install Vertical & Horizontal Strips

Fit vertical strips first, checking spacing and alignment. Once vertical sections are secure, measure and cut horizontal cross pieces to fit between them. Ensure all joints are tight.

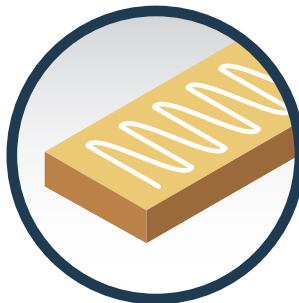

Fill & Finish

Once adhesive has set:

- Fill joints and gaps with decorators caulk or filler.
- Lightly sand smooth when dry.
- Apply MDF primer.
- Finish with two coats of paint.
- This creates a seamless, built-in appearance.

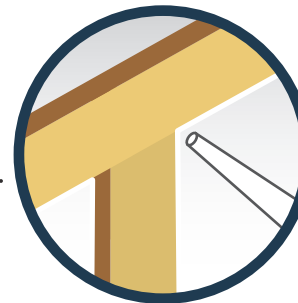

Frequently Asked Questions

Do I need to screw shaker panels to the wall?

High-strength grab adhesive is usually sufficient on flat plastered walls.

Can I install shaker panelling on textured walls?

Walls should be smooth for best results. Textured walls may require preparation.

How long does installation take?

A standard feature wall can typically be installed within one day, excluding drying time for filler and paint.



Copyright 2025 Barkston Plastics. All rights reserved.

Our mailing address is: Barkston Plastics Ltd
221 Pontefract Lane Cross Green Leeds LS9 0DX



Follow the Plastic People:

Follow us on social media for latest news, products and services

Did you know at The Plastic People we also make and manufacture the following:-

- Secondary Glazing
- PVC Wall Cladding
- MDF, Plywood & OSB
- Kitchen Splashbacks
- Bathroom Splashbacks

- Furniture Protectors
- Pictures & Framing
- Plastic Mirrors
- Garden Mirrors
- Child Safe Mirrors

- Horse Mirrors
- Greenhouse Glazing
- Shed Windows
- Cold Frame Glazing
- Protective Screens