

Secondary Glazing | Installation Guide

A step-by-step guide to fitting your bespoke magnetic kit

The lifespan of your secondary glazing depends on the material you use. For instance, both the Plexiglas and Perspex brands of clear acrylic plastic (which we use in our kits) are guaranteed to last for at least 5-10 years before any discolouration or warping occurs.

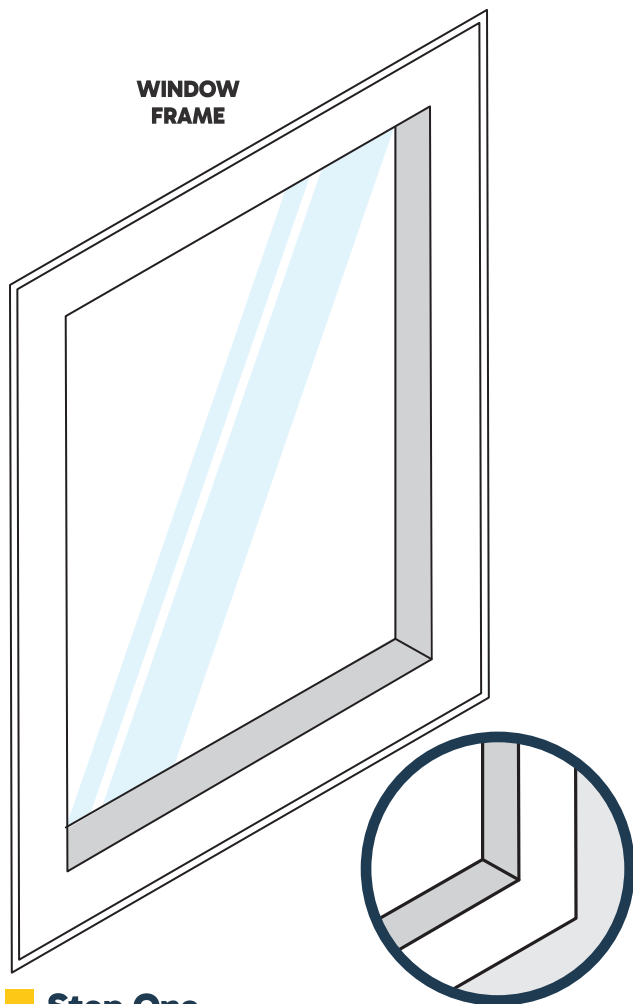

WINDOW
FRAME

WINDOW
FRAME

ACRYLIC
PANEL

Step One

Unpack your acrylic panels and magnetic tapes, check that they are intact. Ensure you have a flat table or surface beforehand when applying your magnetic tape to your acrylic panels. This will avoid any bowing or warping and ensure a tight seal.

Step Two

Find your White metal tape firstly and cut to the appropriate lengths for applying to the window frame (remove backing tape). A pair of scissors or a craft knife are ideal for this purpose. Your magnetic tape will either be 12.5mm or 25mm wide depending on your panel size and kit.

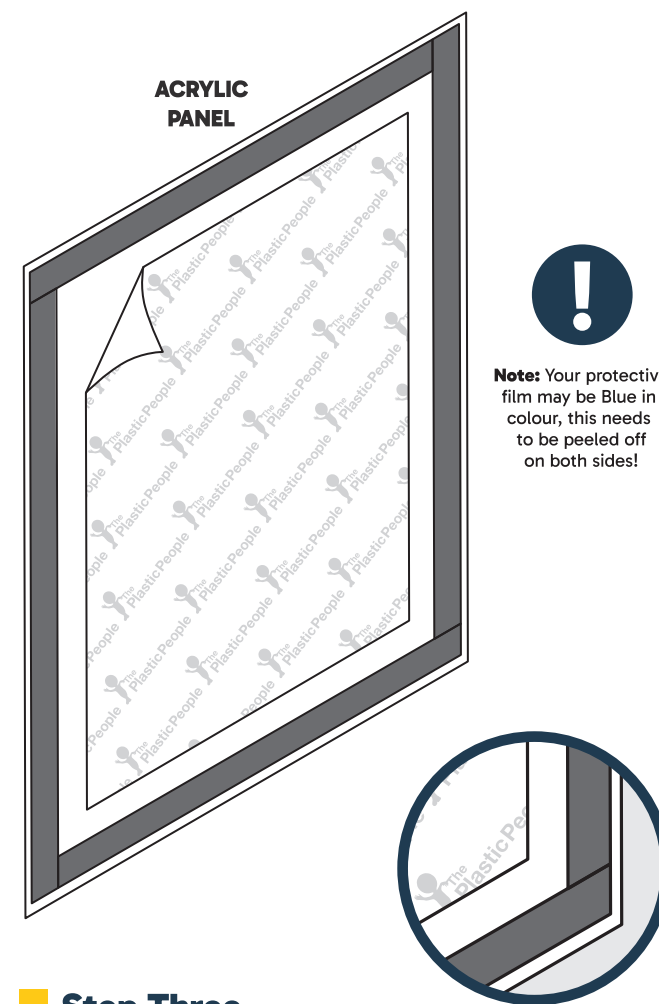

Note: Your protective film may be Blue in colour, this needs to be peeled off on both sides!

Step Three

Take your acrylic panel and place on a flat surface. Apply the Black magnetic tape around the outer edge of the acrylic side that has the film partially removed (remove backing tape). Once completed take off the protective film in the middle. Leave protective film on reverse of your panel until you apply to your window.

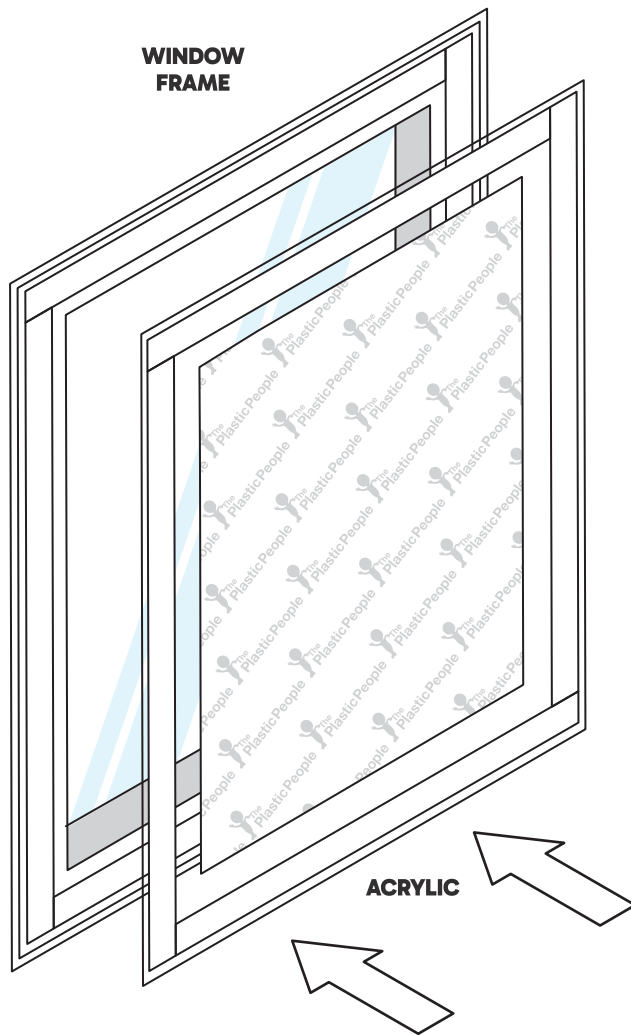

Step Four

Offer up your acrylic panel with applied Black magnetic tape towards the White metal tape surround on your window frame. Gently apply and run your fingers around the edge ensuring a tight seal.

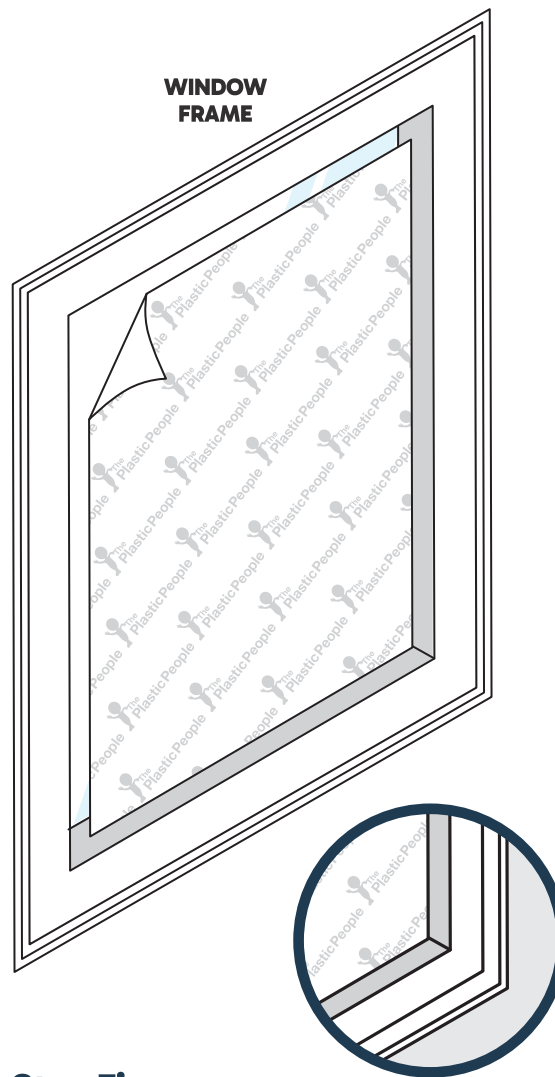

Step Five

When happy with final positioning remove the protective film from the front, peeling carefully. Ensure your seal is good and secure and run your fingers around the outer aspect.

The Benefits of Secondary Glazing

Our secondary glazing is a cheaper double-glazing alternative that keeps your room warm, and helps stop condensation on windows. Your DIY double glazed windows will be cost efficient and easy to install.

Secondary glazing provides an extra layer of protection from your home to the cold, it saves you money on heating bills & virtually eliminates condensation. All while keeping the character of your existing windows.

We provide cost-effective, cut-to-your size or shape clear as glass acrylic glazing (which looks just like a glass counterpart but is around 10 x stronger). Along with your plastic glazing sheets will be magnetic strips to secure your acrylic pane onto your existing window.

Why not take a look at our video installation guide <https://www.youtube.com/watch?v=9EX5AckNKN8>.

IMPORTANT - BUYER BEWARE

For panels with a perimeter less than 4500mm, use 3mm acrylic with Standard tape. For panels with a perimeter greater than 4500mm, use 4mm acrylic with Extreme tape. For perimeters over 4500mm we recommend additional support (Nylon Fixing Clips) as magnetic tape alone will not be enough to support the panel which could potentially detach and break.



Copyright 2025 Barkstons Plastics. All rights reserved.
Our mailing address is: Barkston Plastics Ltd
 221 Pontefract Lane Cross Green Leeds LS9 0DX

Did you know at The Plastic People we also make and manufacture the following:-

- Secondary Glazing
- PVC Wall Cladding
- MDF, Plywood & OSB
- Kitchen Splashbacks
- Bathroom Splashbacks
- Furniture Protectors
- Pictures & Framing
- Plastic Mirrors
- Garden Mirrors
- Child Safe Mirrors
- Horse Mirrors
- Greenhouse Glazing
- Shed Windows
- Cold Frame Glazing
- Protective Screens